



# SPRING BEACH HOLIDAY HOUSE

**EAST COAST OF TASMANIA**

Tasmania, Australia • [www.islandshacks.com](http://www.islandshacks.com)



# WELCOME

Welcome to Spring Beach Holiday House near Orford on Tasmania's east coast. With its million-dollar ocean views and virtually waterfront position on pristine Spring Beach, the house – fully refurbished in 2016 – has been enjoyed by family, friends and guests since the 1970s. We are certain you will, too.

If you love Spring Beach Holiday House, you will also love our other 'island shack' - cosy Carrington Cottage at Dennes Point at the northern tip of famed Bruny Island. For ten years, we have offered to friends and guests this idyllic waterfront cottage on Nebraska Beach.

Enquire about our special deal for staying consecutively at both our wonderful island shacks.



# THE HOUSE

Spring Beach Holiday House, an original vertical board shack from the 1940s, sits at the southern end of Spring Beach and is the closest to the beach of all the houses in the small holiday township.

371 Rheban Road, Spring Beach 7190

# SPRING BEACH AND SURROUNDS

## WINERIES AND PRODUCE

Tasmania's East Coast is renowned for its cool-climate wines and homegrown produce. From our holiday house, take a day trip along the Great Eastern Drive to discover your favourites.

A few minutes' walk from the house is the new *Spring Bay Distillery*, where "Single Malt Whisky is patiently maturing with an expected first release mid-2017..."

## WILDERNESS AND WILDLIFE

Spring Beach and Orford are the gateway to the East Coast's most popular destinations for sailing, diving, watersports, surfing, bushwalking, bikeriding... At the house, keep an eye out for native animals like echidnas, quolls, wallabies, dolphins, the occasional whale...

## CULTURAL HERITAGE

Aboriginal middens dot the coastline. Follow the local convict trails, and Spikey Bridge and Maria Island are popular haunts...



Photos: Grant Gaffney

# THE ACCOMMODATION



## LIVING/DINING

We have extensively refurbished the house, with polished timber floors throughout, a modern kitchen and bathroom, a reverse-cycle heat pump, and a lounge with open fire, LCD TV and DVD.



## BEDROOMS/BATHROOM

Bedroom 1 – One queen bed.  
Bedroom 2 – One queen bed and a single bed  
Bedroom 3 – Two bunk beds and a fold-out bed  
The modern bathroom has a toilet and walk-in shower, and there is a separate toilet and laundry.



## OUTSIDE LIVING

French doors open to a large timber deck facing the ocean. Rinse beach sand off under the hot-and-cold deck shower, or relax with a glass of wine in our outdoor bath. Cook your freshly-caught fish on a wood- or gas-fired BBQ, and enjoy our brazier.



Photo: Grant Gaffney

# Spring Beach Holiday House Site Layout

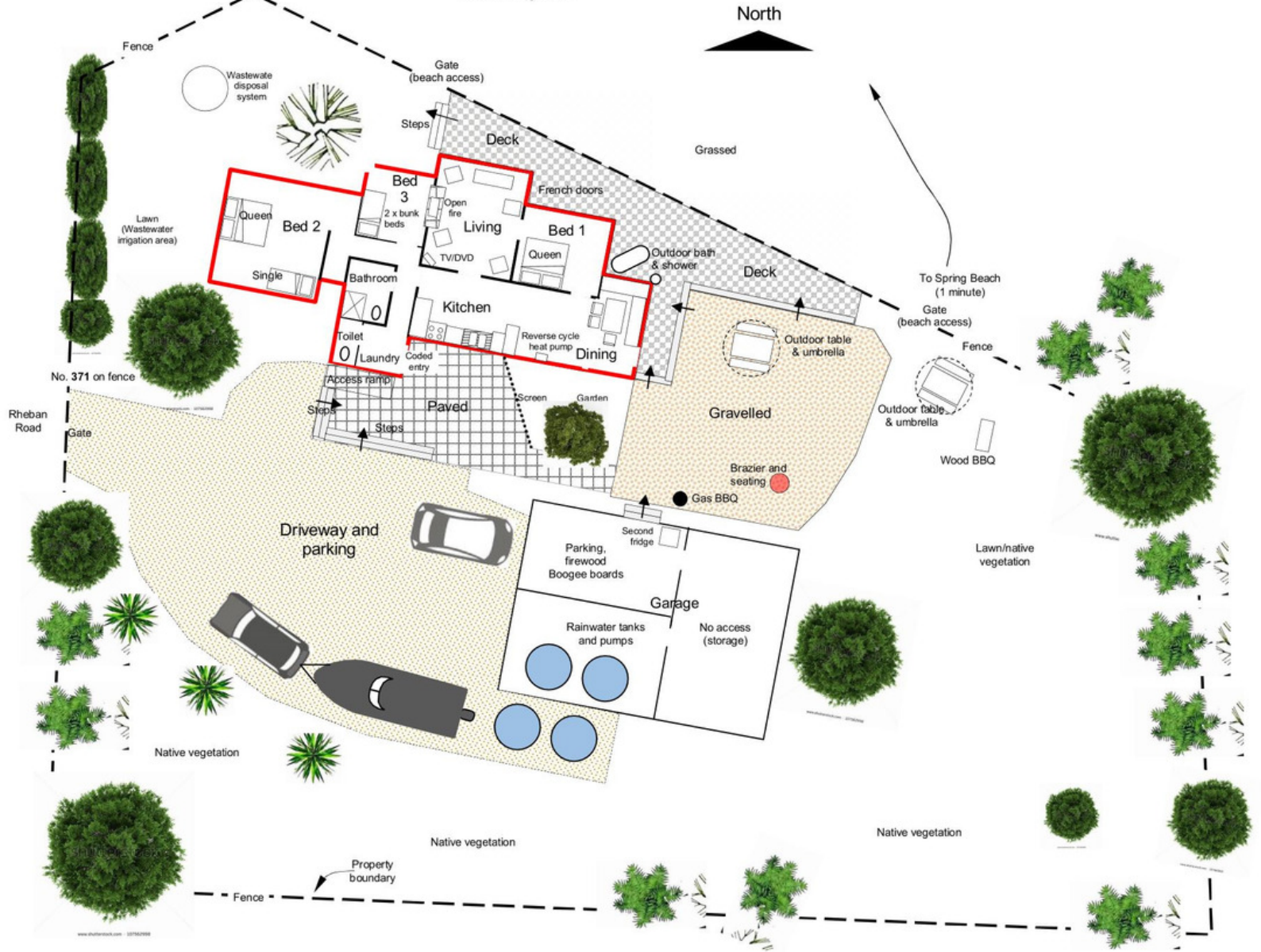



## WHAT TO BRING

Bring all food, toiletries and beach towels.

Spring Beach is 5 minutes' drive from Orford and its supermarket, pub, newsagency and post office, deli, café and restaurants. We recommend *Scorchers by the River Gallery Cafe* (for coffee and woodfired pizza), and the next-door *Gateway Cafe*. The supermarket is also very well stocked.

Spring Beach Holiday House is strictly non-smoking. We do not allow pets anywhere on the property.



## WE PROVIDE

We provide, free of charge: basic foods (coffee, tea, pepper, salt, sugar...), firewood for the open fire (and a safety firescreen); pressurised water from rainwater tanks (we recommend that you boil all drinking water).

NOTE: We do not provide a cleaning service during your stay.



## **RATES**

Please enquire about our rates at [info@islandshacks.com](mailto:info@islandshacks.com). The base nightly rate is for two people, for two or more nights.

Additional charges apply for each extra person per night. There is no charge for infants in cots (cot provided) and babies.

Spring Beach Holiday House is also available for single nights, but conditions apply.

Rates are subject to change without notice.

## **CHECK-IN**

Check-out time is 10am; check-in time is 2pm. These times can be varied by prior arrangement.

## **DIRECTIONS**

From Hobart, take the Tasman Highway (A3) over the Tasman Bridge, through Sorell, to Orford at the mouth of the Prosser River. Immediately before the bridge over the Prosser River, turn hard right past the supermarket onto the sealed main street (Charles Street, which becomes Rheban Road; C320).

Continue south on Rheban Road for about 4km (5 minutes) to Spring Beach. Drive down the hill to the beach and continue south for about 200m to a small timber bridge. The Spring Beach Holiday House is the first house on the left up the hill after the bridge (about 200m). Number '371' is on the white fence.



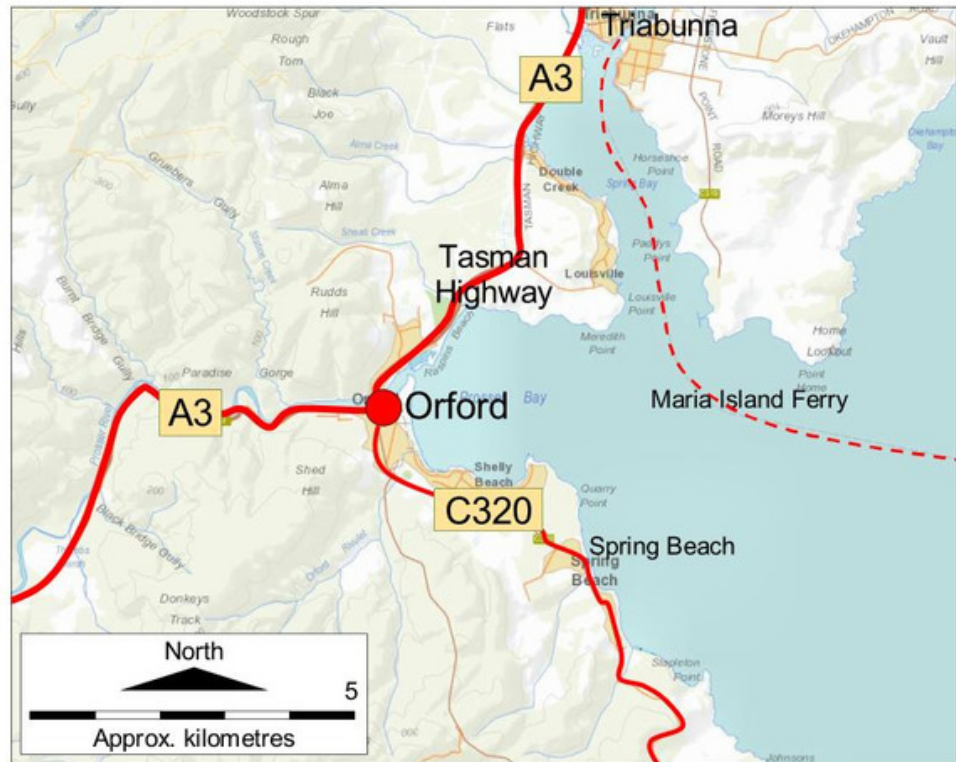



Photo: Grant Gaffney

# THANK YOU

FOR MORE INFO, VISIT [WWW.ISLANDSHACKS.COM](http://WWW.ISLANDSHACKS.COM)

Tasmania, Australia • +61 (0)498 372 273 • [info@islandshacks.com](mailto:info@islandshacks.com)